

# Monorail Tracks

CG50

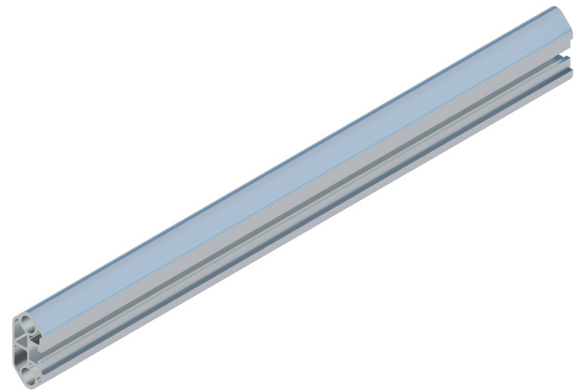
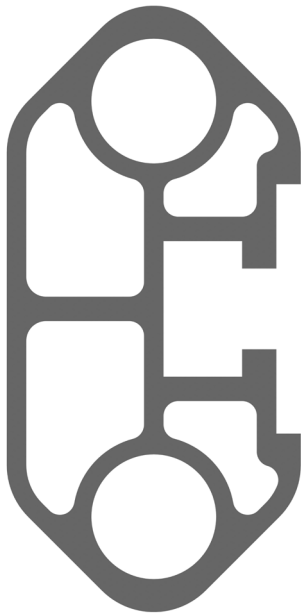

<b>Design Standard</b>	EN 1808
<b>Track Type</b>	CG50
<b>Dimensions</b>	124 mm x 84 mm
<b>Weight</b>	6.45 kg/m
<b>Yield Limit</b>	160 N/mm <sup>2</sup> 240 N/mm <sup>2</sup>
<b>Minimum Horizontal Bend Radius</b>	900 mm
<b>Typical Bracket Span</b>	2.0 m - 3.0 m
<b>Bracket Fastening</b>	Side
<b>Fastening Method</b>	2 x M16 bolts for each bracket
<b>Material</b>	Aluminium alloy 6063-T6 Aluminium alloy 6061-T6
<b>Finish</b>	Mill finish
<b>Optional Surface Treatment</b>	Anodized
<b>Optional Colors</b>	RAL 7004 RAL 9001

The CoxGomyl™ monorail is the ideal façade maintenance system for buildings with limited roof space. It can be installed with minimum visual impact respecting the architectural aesthetic. It consists of aluminium tracks in combination with the CoxGomyl trolley range and suspended platforms or as an abseil solution.

CoxGomyl CG50 tracks are designed for side arrangement. Suitable for indoor and outdoor installations.

*CoxGomyl trolleys must be used with the CG50 track.*